

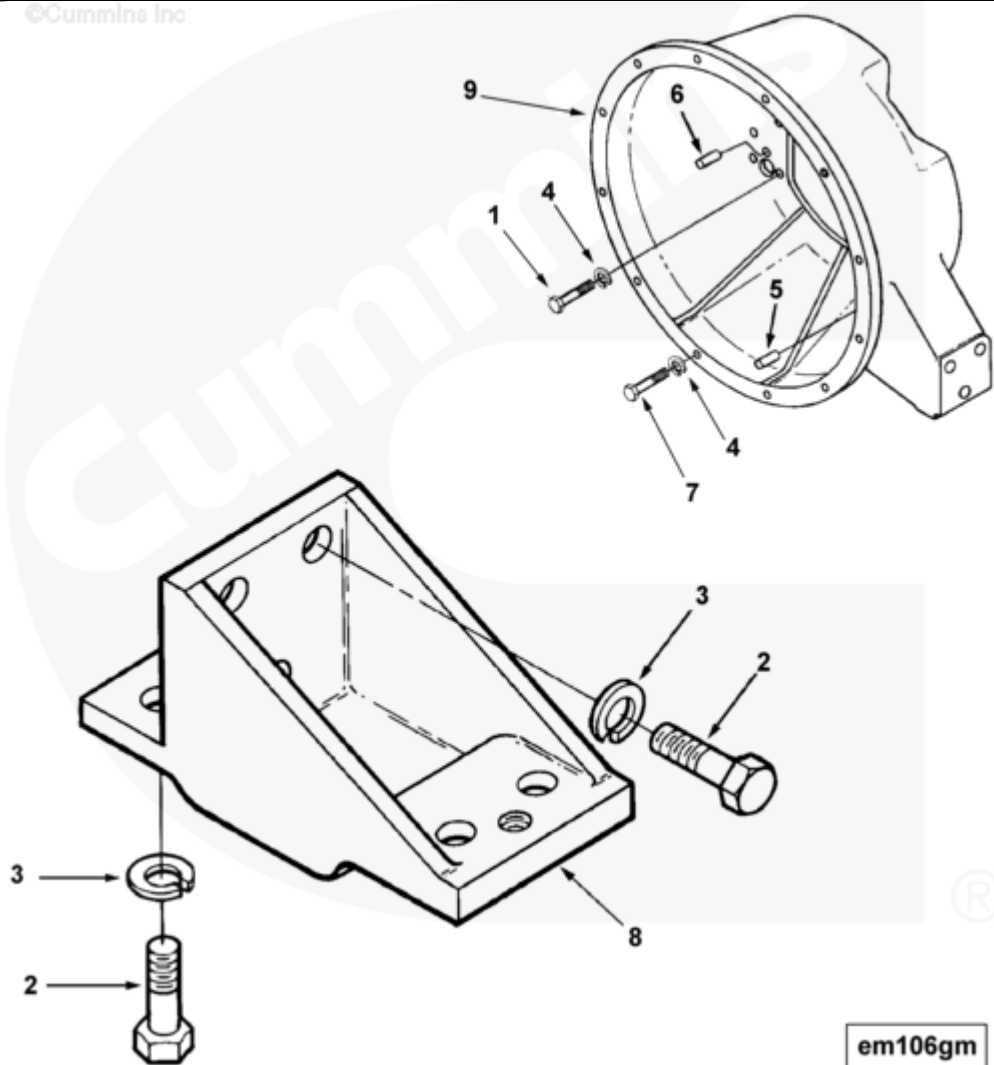

## Parts Catalog - Option Detail

Electronic Parts Catalog - Option Detail				
Option	Group	Graphic	Film Card	Date
EM1345	16.03	em106gm	FF	27-AUG-99
<b>Engines</b>	G855, G855 CM558, GTA855 CM558 (CM2358) G101, N14 CELECT, N14 CELECT PLUS, N14 MECHANICAL, NH/NT 855, QSM11 CM876 M101, QSM11 CM876 M102M, QSN14 CM876 N103, QSN14 CM876 N105, QSNT14 CM876 N102			



SMALL | MEDIUM | LARGE

Cart	Ref No	Part Number	Part Description	Required	Remarks
View My Cart					
		EM1345	Front Engine Support		
					Combination front engine

					support and bell- housing for
					over running clutch type
					front
					Power take-off.
					Does not include an adapter
					for clutch.
					Includes marine mounting feet
					with mounting surface located
					9.51inches (241.4mm) below
					crank centerline.
<input type="checkbox"/>	1	<a href="#">S 116 C</a>	Hexagon Head Cap Screw	11	7/16 - 20 x 3 1/2 inch
<input type="checkbox"/>	2	<a href="#">S 127 C</a>	Hexagon Head Cap Screw	10	5/8 - 11 X 1 3/4 Inch.
<input type="checkbox"/>	3	<a href="#">S 603</a>	Lock Washer	10	5/8 in.
<input type="checkbox"/>	4	<a href="#">S 610</a>	Lock Washer	13	7/16 in.
<input type="checkbox"/>	5	<a href="#">60408</a>	Pin Dowel	1	
<input type="checkbox"/>	6	<a href="#">70653</a>	Diamond Dowel	1	
<input type="checkbox"/>	7	<a href="#">103023</a>	Hexagon Head Cap Screw	2	7/16 - 14 X 1 in.
<input type="checkbox"/>	8	<a href="#">3010348</a>	Engine Support	2	
<input type="checkbox"/>	9	<a href="#">3010372</a>	Power Take-Off Housing	1	